



IAE spa  
via F. Filzi 53  
20032 CORMANO MI  
tel. +39 02 66303255  
fax +39 02 6152544  
e-mail [iaexray@iae.it](mailto:iaexray@iae.it)

# C40

Rotating anode X-ray tube unit  
for general diagnostic systems

## Application

Rotating anode X-ray tube unit specifically designed for 80 mm anode diameter inserts, for radiographic and fluoro procedures.



## Characteristics

- Lead lined aluminium body.
- Filled under vacuum with insulating oil, specially processed.
- Two devices are present for thermal safety:
  1. a bimetallic thermal switch, internally assembled, series connected with stator common cable
  2. a pressure switch
- Storage and shipment temperature range  $-10^{\circ}\text{C} \div +80^{\circ}\text{C}$
- No user maintenance requested

## Inserts for reloading

- X39
- X42

## Specifications

Overall length	489 mm
Maximum diameter	152 mm
Tube assembly net weight	16 kg
Nominal X-ray tube assembly voltage	125 kV
Maximum tube assembly heat content	900 kJ
Maximum continuous heat dissipation	180 W
Minimum tube assembly inherent filtration	1.0 mm Al / 75 kV
Maximum leakage radiation at 1 m from focal spots	0.44 mGy/h

C40 Rev 0 - 21.02.2013



## Dimensions

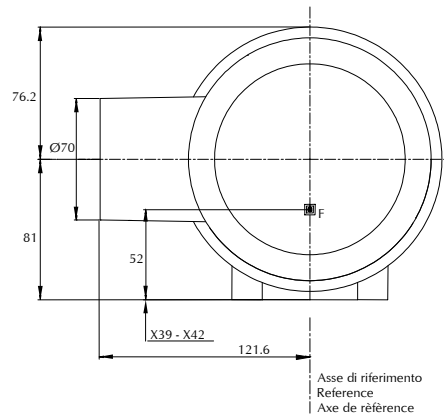
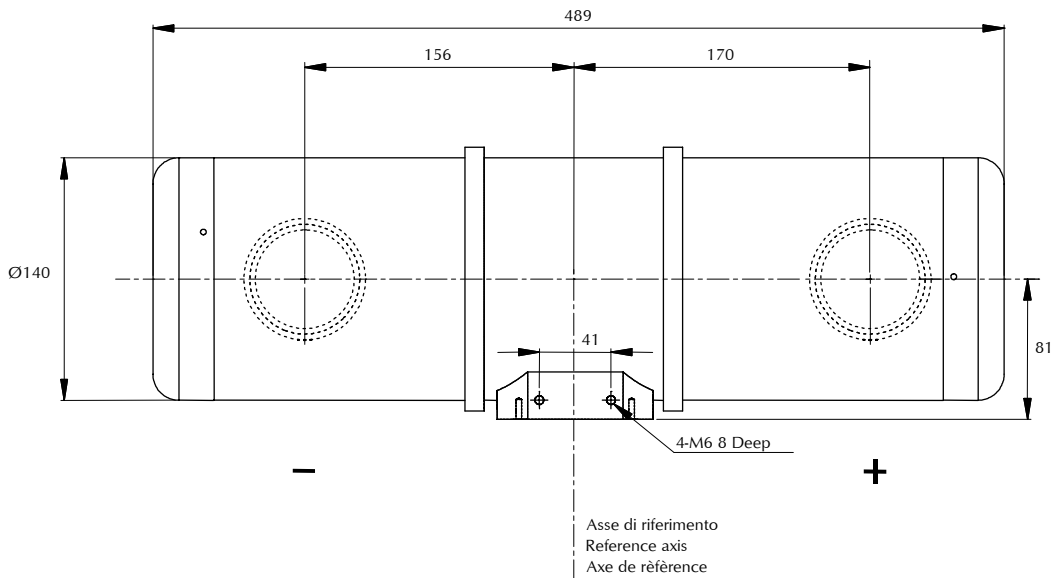

## Tube assembly heating and cooling curves

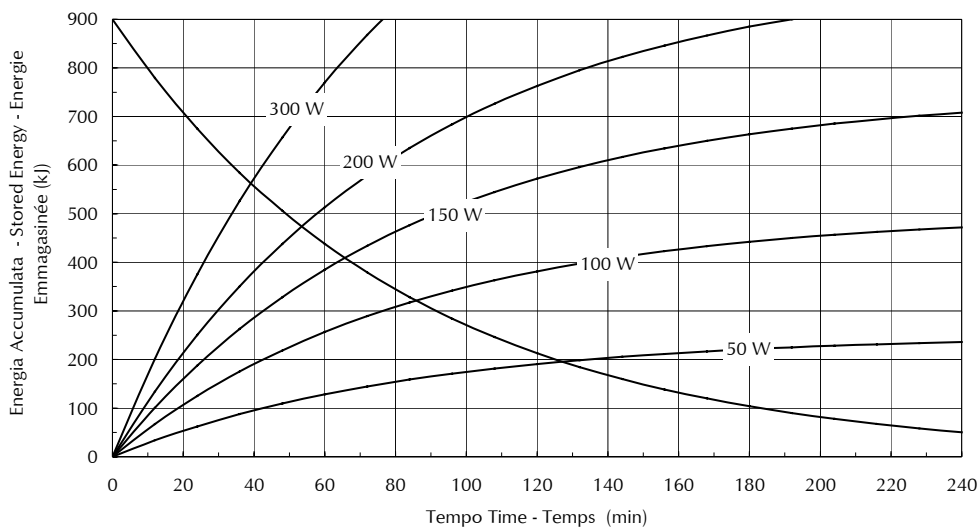

Should you have questions about the compatibility of a replacement tube unit call our customer service: +390266303255.

© copyright iae spa  
Data may vary without notice



**IAE spa**  
via F. Filzi 53  
20032 Cormano MI - Italy  
tel. +39 02 66303255  
fax +39 02 6152544  
e-mail iaexray@iae.it